

Current part is item (1) on diagram. Available at [www.oshkoshequipment.com](http://www.oshkoshequipment.com)

(1) (a) FIG. NO.	(2) (b) ITEM NO.	(3) SMR CODE	(3) NATIONAL STOCK NUMBER	(4) PART NUMBER	(5) FSCM	(6) DESCRIPTION USABLE ON CODE	(7) U/M	(8) INC IN UNIT
1204-HYDRAULIC BRAKE SYSTEM (CONT'D)								
117	34	PAOZZ	4720-00-203-9515	7409330	19207	HOSE ASSEMBLY,RUBBER: TEE TO FRONT AXLE BRAKE WHEEL CYLINDER LINE	EA	2
117	35	PAOZZ	4710-00-752-9366	7529366	19207	TUBE ASSEMBLY,METAL: FRONT AXLE BRAKE LINE TEE TO LEFT FRONT AXLE BRAKE HOSE	EA	1
117	36	PAOZZ	4710-00-752-9367	7529367	19207	TUBE ASSEMBLY,METAL: TEE TO FRONT AXLE BRAKE HOSE, RIGHT	EA	1
117	37	PAOZZ	5305-00-042-3569	423569	21450	SCREW,ASSEMBLED WASHER	EA	2
117	38	PAOZZ	5340-00-487-5458	7539378	19207	BRACKET,ANGLE: BRAKE HOSE AXLE, LH	EA	1
117	38	PAOZZ	2530-00-179-7118	7529379	19207	BRACKET,BRAKE HOSEW: AXLE,RH	EA	1
117	39	PAOZZ	4730-00-737-3252	7373252	19207	TEE,MULTIPLE: FLUID PRESSURE LINE, FRONT AXLE BRAKE LINE	EA	1
117	40	PAOZZ	4710-00-129-5333	10937711	19207	TUBE ASSEMBLY,METAL: FRAME TEE TO FRONT AXLE BRAKE HOSE	EA	1
117	NI	PAOZZ	4710-00-040-2032	7368617	19207	TUBE ASSEMBLY,METAL: LOCK TO BOOSTER CYLINDER (M60,M108)	EA	1
117	NI	PAOZZ	4710-00-040-2033	7368618	19207	TUBE ASSEMBLY,METAL: LOCK TO TEE (M60,M108)	EA	1
117			5340-00-854-6729	MS21333-103		CLAMP,LOOP: FRONT WHEEL CYLINDER HOSE	EA	2
117			5360-00-516-7466	5167466		SPRING,HELICAL: FRONT WHEEL CYLINDER HOSE	EA	2
117			2530-00-908-8162	10883281		PLATE: FRONT WHEEL CYLINDER HOSE SPRING	EA	2
117			5305-00-267-8973	MS90726-4		SCREW,CAP,HEXAGON: FRONT WHEEL CYLINDER HOSE CLAMP	EA	2
117			5310-00-061-7325	MS21045-4		NUT,SELF-LOCKING: FRONT WHEEL CYLINDER HOSE CLAMP SCREW	EA	2
118	1	PAOZZ	5306-00-022-0738	MS35763-865	96906	BOLT,SELF-LOCKING	EA	1
118	2	PAOZZ	5306-00-515-7537	AN7-5A	19207	BOLT,MACHINE	EA	2
118	3	PAOZZ	2530-00-753-9382	7539382	19207	SHIELD: AIR HYDRAULIC CYLINDER	EA	1
119	1	PAOFF	2530-00-040-2188	8345003	19207	UNIT ASSEMBLY: AIR HYDRAULIC	EA	1
119	67	PAOZZ	2530-00-287-8252	7539268	19207	BLEEDER, VALVE, HYDRAULIC	EA	1

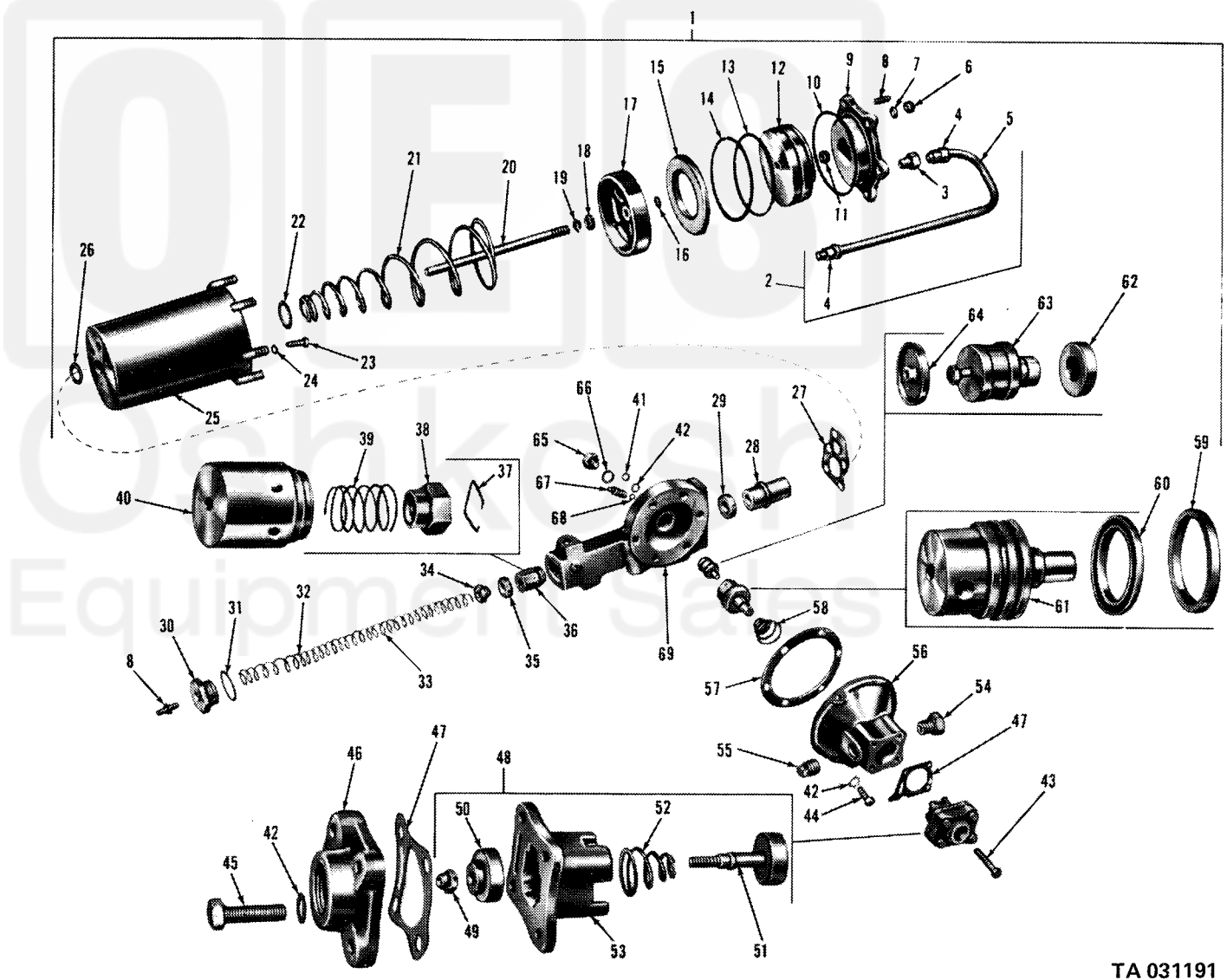

Current part is item (1) on diagram. Available at [www.oshkoshequipment.com](http://www.oshkoshequipment.com)



TA 031191

Figure 119. Air hydraulic unit assembly - exploded view.